



Urological Association of Physician Assistants

5<sup>th</sup> Annual Meeting

April 1 – 3, 2016

Wyndham Lake Buena Vista Resort

Lake Buena Vista, Florida

# PROGRAM BOOK



Welcome to the UAPA 5<sup>th</sup> Annual Meeting! I would like to thank each of you for joining us here in Orlando, Florida as we anticipate another great meeting.

Our meetings strive to continue to meet the needs of PAs in practice. We are offering educational opportunities on topics that were recommended by the attendees of last year's meeting and they will cover various aspects of urology. All lectures and hands-on sessions are dedicated to broaden the knowledge base for PAs in urology since we are being asked to do more diverse care in our clinics every day. This meeting will include hands-on sessions to enhance your procedure skills, further your knowledge on Urodynamics, Pessaries and Female Sexual Dysfunction.

Some key highlights to this year's meeting include: Prostate and Bladder Cancer Treatments and Management, Voiding Dysfunction, Infertility, and Urodynamics. One of the biggest highlights is the ability to obtain Self-Assessment CME to help fulfill NCCPA guidelines from two of the activities provided at the meeting.

The Welcome Reception will take place Friday, April 1. We encourage you to interact with your colleagues, industry partners and both new and old friends from across the country during these events. Additionally, there will be other opportunities to interact with our industry members throughout the meeting in the exhibit hall. We certainly encourage you to visit with our industry partners, as their ongoing support continues to allow UAPA to grow, and the UAPA meeting to flourish.

Please join us in thanking the Program Committee, WJ Weiser & Associates, sponsors and exhibitors for their hard work and perseverance in bringing this all together. Also make sure to get out and enjoy Orlando. There are several restaurants, attractions, theme parks within reach!

Jessica Nelson, MPAS, PA-C  
UAPA Education Committee Chair



Welcome to sunny Orlando and the 5<sup>th</sup> annual UAPA conference!

This year's conference is packed with three days of lectures and hands-on sessions covering the basics to some of the newest ideas in our field. I believe there will be something of interest for everyone in attendance.

In addition to the core CME credits, this year we are offering two self-assessment credits for those of you needing to fulfill your NCCPA requirements this cycle. I am optimistic that in the future, we will be able to continue with this tradition.

This meeting was made possible by a collaborative effort between our education committee, industry sponsors and our management group, W.J. Weiser. I can't stress enough the importance of industry sponsors to the success of our program, and I encourage you to join me in thanking them and visiting with them in the exhibit area. Thank you also to our education committee chair, Jessica Nelson, along with her team in creating a wonderful program.

As UAPA President, I decided one of my goals would be to create a network of Urology PAs willing to be student preceptors. I am pleased to announce the development of a urology preceptor directory. This is a new concept being created in cooperation with the PAEA and should be a great resource for students who may be interested in urology as a specialty. UAPA will be the first constituent organization to take part in this endeavor. I am hopeful this will also encourage students to join the UAPA and encourage more PAs to join our specialty.

Our committees are also the key to our growth as an organization. Committee chairs will be available throughout the conference to speak with you and give you an idea of the time commitment involved. I encourage you to explore the various committees and to get involved. We need you!!

This is an exciting time for our organization. As we continue to make connections with other organizations such as the PAEA, AUA and the Urology Care Foundation, our exposure in the healthcare arena will grow and hopefully, as a result, our membership will continue to grow as well.

Once again on behalf of the Board of Directors, welcome to Orlando!

Charlene Kreiensieck, PA-C, MPAS  
UAPA President

**2015 -2016 Board of Directors****President**

Charlene Kreiensiack, MPAS, PA-C  
Laconia Clinic  
724 Main St., PO Box 637  
Laconia, NH 03247-0637

**President-Elect**

Richard D. Ulstad, MS, PA-C, CCD  
Urology Associates of Southeastern North Carolina  
309 Castle St.  
Wilmington, NC 28401

**Vice President**

Shawn McGlew, PA-C, DFAAPA  
442 Civic Center Drive  
Augusta, ME 04330

**Secretary**

Jessica Nelson, MPAS, PA-C  
UT Southwestern Medical Center  
7910 Eagle Trail  
Dallas, TX 75238

**Treasurer**

James R. Kovarik, III, PA-C  
University of Kansas Hospital  
3901 Rainbow Blvd.  
Kansas City, KS 66160

**Past President**

Richard Pasquarella, PA-C  
McLeod Regional Medical Center  
6019 302nd Street  
Stacy, MN 55079

**Delegate to the AAPA HOD**

Wanda C. Hancock, MHSA, PA-C  
VA HCC  
4406 Susanna Court  
Farmville, NC 27828-8530

**AUA Representative**

Timothy Irizarry, MS, NREMT-P, PA-C  
Barg Family Clinic  
11415 Executive Center Drive  
Little Rock, AR. 72211

**Program Committee**

Jessica Nelson, MPAS, PA-C, Program Chair  
Brad J. Hornberger, MPAS, PA-C  
Charlene Kreiensiack, PA-C, MPAS  
Mary Mathe, PA-C  
Thomas McBride, PA-C  
Kenneth Mitchell, MPAS  
Richard D. Ulstad, MS, PA-C, CCD  
Gwendolyn B. Zilinskas, MMS, PA-C

**Executive Office**

Two Woodfield Lake  
1100 E Woodfield Road, Suite 350  
Schaumburg, IL 60173  
P: (847) 517-7225  
F: (847) 517-7229

**Executive Director**

Heather Swanson



5<sup>th</sup> Annual Meeting  
 April 1 – 3, 2016  
 Lake Buena Vista, Florida

Message from the Program Chair ..... 1  
 Message from the President..... 2  
 2015 – 2016 Board of Directors..... 3  
 Educational Needs and Objectives..... 5  
 CME Accreditation ..... 6  
 General Meeting Information & Map of Hotel ..... 7  
 Promotional Partners & Exhibitors..... 8  
 Industry Satellite Symposium Events ..... 9  
 Scientific Program ..... 10  
 Speaker Biographies ..... 14

**Educational Needs**

The National Commission on Certification of Physician Assistants census in 2014 estimated 1.4% of the 101,977 licensed PAs were practicing urology. The State of the Urology Workforce published by AUA as of May 2015 confirmed the aging of the urologic workforce reporting more than half of the 11,703 identified practicing urologists, nearly 23 percent are aged 65 years or older. As we have known for years, the work force shortage can be supplemented by physician assistants. In order to fill this need, physician assistants in urology should understand the conditions leading to urology workforce issues and be able to illustrate to stake holders the conditions that optimize productivity.

We will focus several talks on urologic malignancies. Management of urologic malignancies includes multiple modalities that require that physician assistants to understand current issues regarding diagnosis, treatment choices as well as management once treatment has been completed. Because physician assistants are often the source of patient education regarding management of the long term complications of cancer treatment, it is also necessary to provide them with clinically relevant information regarding patient survivorship.

With the rapid growth of integrating physician assistants into urology practices comes the need to provide training in urologic procedures including female and male sexual dysfunction, cystoscopy, urodynamic testing, pessary fitting, neuromodulation.

**Educational Objectives**

1. Recognize the wide array of available prostate cancer testing choices and learn how to use the correct test for each individual patient circumstance.
2. Identify common pediatric genital anomalies and associated treatments.
3. Describe the process of diagnosing patients with presumed interstitial cystitis.
4. Recognize the impact of ICD-10 on documentation and practice in Urology.
5. Illustrate female bladder dysfunction procedures/surgical interventions.
6. Explain the principles and rationale of testosterone replacement therapy (TRT).
7. Identify current controversies surrounding testosterone replacement therapy.
8. Assess LUTS due to BPH with or without erectile dysfunction.
9. Interpret and explain the appropriate diagnosis, prevention and treatment of castration resistant prostate cancer.
10. Describe the AUA guidelines for management of Urologic Malignancies.
11. Explain simplified Urodynamics: How does the bladder fill, how does it empty, is the urethra competent during the filling and voiding?
12. Identify the tests and procedures used in the diagnosis of bladder cancer.
13. Describe the cystectomy surgical techniques and urinary diversion.
14. Plan Erectile Dysfunction surgical management.
15. Define and rationalize antibiotic stewardship.
16. Practice radiologic evaluation of flank pain and hematuria.
17. Identify possible causes of male infertility.
18. Describe indications for cystoscopy and for using cystoscopic guidance for catheter placement.
19. Describe the proper evaluation and work up when making the diagnosis of Peyronie's Disease.
20. Describe the evaluation for a patient with female sexual dysfunction.
21. Describe basic urodynamic diagnoses.

## Accreditation Statements

### CME Accreditation Statement

This program has been reviewed and is approved for a maximum of **16.25** hours of *AAPA Category 1 CME credit* by the Physician Assistant Review Panel. Physician assistants should claim only those hours actually spent participating in the CME activity.

This program was planned in accordance with AAPA's CME Standards for Live Programs and for Commercial Support of Live Programs.



### Self-Assessment CME Accreditation Statement

This Self-Assessment CME program has been reviewed and is approved for a maximum of **2.00** AAPA Category 1 Self-Assessment CME credits by the Physician Assistant Review Panel. Approval is valid for one year from the release date of 04/01/2016. Physician Assistants should claim only the credit commensurate with the extent of their participation in the activity. This program was planned in accordance with AAPA's CME Standards.



### Disclosure Report

The Disclosure Report for this meeting may be found at: <http://tinyurl.com/2016-Disclosure-Report>

### Conflict Resolution Statement

The American Academy of Physician Assistants (AAPA) has implemented a process to identify and resolve conflicts of interest that may exist which might affect the independence and fair balance of an educational activity. All planning committee members, authors and speakers were required to disclose relevant financial relationships with any commercial interest providing support for this program. Potential conflicts of interest were resolved and documented by one or more of the following methods: 1) Altering the individual's financial relationships, 2) Altering the individual's control over content; or 3) Conducting an independent validation of the individual's presentation content. Individuals who refused to or otherwise failed to disclose potential conflicts of interest to the AAPA were disqualified from participation in planning or implementing this CME activity.

### General Disclaimer

The statements and opinions contained in this program are solely those of the individual authors and contributors and not of the UAPA. The appearance of the advertisements is not a warranty, endorsement, or approval of the products or services advertised or of their effectiveness, quality, or safety. The content of this publication may contain discussion of off-label uses of some of the agents mentioned. Please consult the prescribing information for full disclosure of approved uses. The UAPA disclaims responsibility for any injury to persons or property resulting from any ideas or products referred to in the abstracts or advertisements.

### Special Assistance

We encourage participation by all individuals. If you have a disability, advance notification of any special needs will help us better serve you. Call (847) 517-7225 if you require special assistance to fully participate in the meeting.

**General Meeting Information**

**Registration/Information Desk Hours**

Location: Horizons Ballroom Foyer, Mezzanine Level

Friday, April 1, 2016 7:00 a.m. – 6:15 p.m.  
 Saturday, April 2, 2016 7:15 a.m. – 6:00 p.m.  
 Sunday, April 3, 2016 7:15 a.m. – 10:30 a.m.

**Exhibit Hall Hours**

Location: Horizons Ballroom, Salon 9-11, Mezzanine Level

Friday, April 1, 2016 7:00 a.m. – 4:15 p.m.  
 Welcome Reception 6:30 p.m. – 8:00 p.m.  
 Saturday, April 2, 2016 7:00 a.m. – 11:00 a.m.

Registration Fee Includes:

- Entrance to Scientific Sessions
- Breakfast (each day)
- One Admission to Welcome Reception
- Program Materials

**Evening Function**

**Welcome Reception**

Date: Friday, April 1, 2016  
 Time: 6:30 p.m. – 8:00 p.m.  
 Location: Exhibit Hall; Horizons Ballroom, Salon 9-11, Mezzanine Level  
 Attire: Business Casual  
 Cost: One admission included with registration fee

**Horizons Ballroom & Solar Room**  
(mezzanine level)

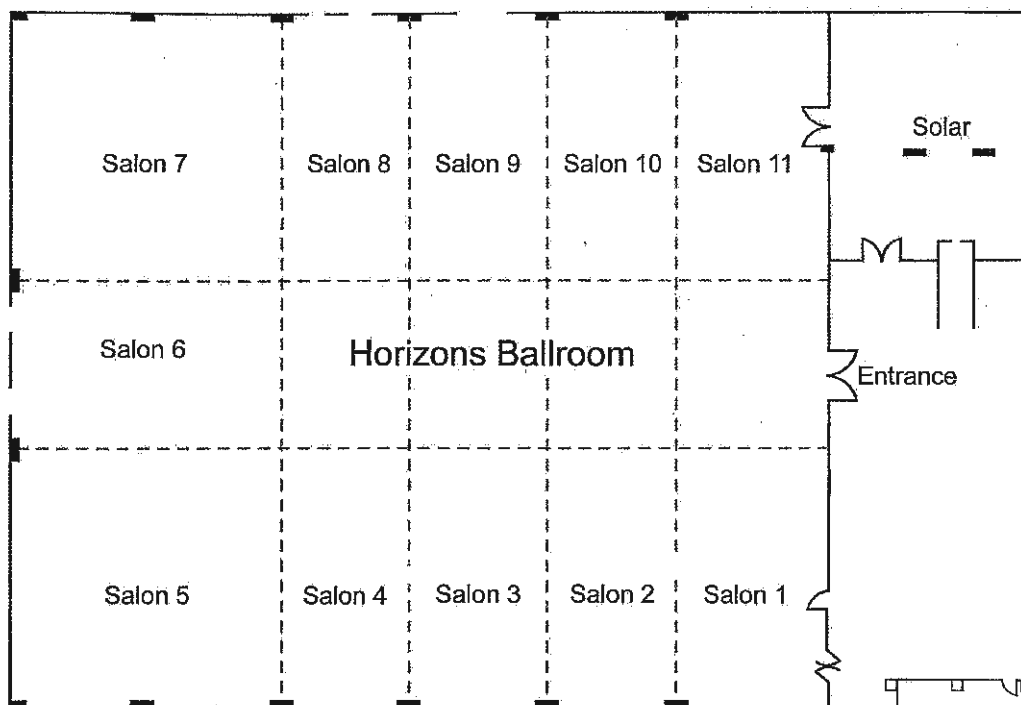

**Lakes Conference Center**  
(lobby level)

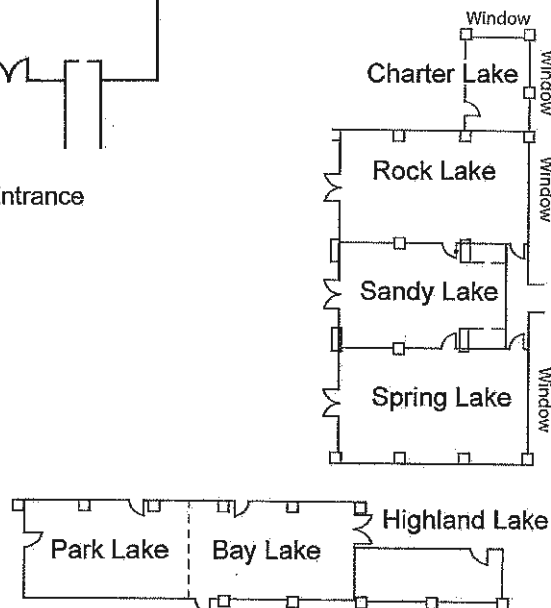



**Thank You to Our 2016 Promotional Partners**

*(as of 3/24/2016)*

**Platinum Level Package**

AbbVie

Genomic Health

Medivation/Astellas

**Gold Level Package**

Janssen Biotech, Inc.

**Silver Level Package**

Astellas Pharma US, Inc.

Endo Pharmaceuticals

**Thank You to Our 2016 Exhibitors**

*(as of 3/24/2016)*

AbbVie

American Urological Association, Inc.

Astellas Pharma US, Inc.

Boston Scientific Corporation

Cogentix Medical

Coloplast

Endo Pharmaceuticals

GenomeDx Biosciences Inc.

Genomic Health

Janssen Biotech, Inc.

MDxHealth

Medivation/Astellas

Medtronic, Inc.

Retrophin

## Please Be Sure to Attend the Following Industry Satellite Symposium Events

**Friday, April 1, 2016****12:30 p.m. – 2:00 p.m.****Industry Satellite Symposium Lunch***Location: Horizons Ballroom, Salon 1-3, Mezzanine Level***“Oncotype DX® GPS: Increasing Confidence in Treatment Decisions for Clinically Low-risk Prostate Cancer Patients”****Mary E. Mathe, PA-C**

Florida Urology Associates

Orlando, FL

**Saturday, April 2, 2016****7:15 a.m. – 8:30 a.m.****Industry Satellite Symposium Breakfast***Location: Horizons Ballroom, Salon 1-3, Mezzanine Level***“Patient Care in Metastatic CRPC: The Role of XTANDI® (enzalutamide) Capsules”****Sarah Sledge, PA-C**

Regional Urology

Shreveport, LA

**Saturday, April 2, 2016****12:00 p.m. – 1:00 p.m.****Industry Satellite Symposium Lunch***Location: Horizons Ballroom, Salon 1-3, Mezzanine Level***“Treatment for Adult Male Hypogonadism Due to an Associated Medical Condition”****Zamip Patel, MD**

Florida Hospital - Celebration Health

Orlando, FL

## UAPA 5th Annual Meeting

April 1 - 3, 2016

Lake Buena Vista, Florida

*All sessions will be located in **Horizons Ballroom, Salon 5 – 7, Mezzanine Level**, unless otherwise noted.  
Speakers and times are subject to change.*

### FRIDAY, APRIL 1, 2016

#### OVERVIEW

- 7:00 a.m. - 8:00 a.m.**      **Breakfast in Exhibit Hall**  
*Location:      Horizons Ballroom, Salon 9-11, Mezzanine Level*
- 7:00 a.m. - 4:15 p.m.**      **Exhibit Hall Open**  
*Location:      Horizons Ballroom, Salon 9-11, Mezzanine Level*
- 7:00 a.m. - 6:15 p.m.**      **Registration/Information Desk Open**  
*Location:      Horizons Ballroom Foyer, Mezzanine Level*
- 6:30 p.m. - 8:00 p.m.**      **Welcome Reception in Exhibit Hall**  
*Location:      Horizons Ballroom, Salon 9-11, Mezzanine Level*

#### GENERAL SESSION

- 8:00 a.m. - 8:05 a.m.**      **Welcome Address**
- 8:05 a.m. - 8:45 a.m.**      **Prostate Cancer Biomarkers**  
Speaker:      Mary Mathe, PA-C
- 8:45 a.m. - 9:30 a.m.**      **What PA's Should Know About Pediatric Urology**  
Speaker:      Tim Hirsch, PAC
- 9:30 a.m. - 10:00 a.m.**      **Self-Assessment Module: IC Treatment**  
Speaker:      Charlene Kreiensieck, PA-C, MPAS
- 10:00 a.m. - 10:30 a.m.**      **Break - Visit with Exhibitors**
- 10:30 a.m. - 11:30 a.m.**      **ICD-10 Coding**  
Speaker:      Mark N. Painter
- 11:30 a.m. - 12:30 p.m.**      **Female Bladder Dysfunction**  
Speaker:      Mathew Oommen, MD
- 12:30 p.m. - 2:00 p.m.**      **Industry Satellite Symposium Lunch**  
*Location:      Horizons Ballroom, Salon 1-3, Mezzanine Level*  
*See page 9 for details.*
- 2:00 p.m. - 2:45 p.m.**      **Testosterone Replacement**  
Speaker:      Kenneth Mitchell, MPAS
- 2:45 p.m. - 3:45 p.m.**      **BPH/LUTS**  
Speaker:      John D. Andrich, PA-C
- 3:45 p.m. - 4:15 p.m.**      **Break - Visit with Exhibitors**  
*Location:      Horizons Ballroom, Salon 9-11, Mezzanine Level*
- 4:15 p.m. - 5:00 p.m.**      **Castrate Resistant Prostate Cancer**  
Speaker:      Richard D. Ulstad, MS, PA-C, CCD
- 5:00 p.m. - 6:30 p.m.**      **Self Assessment Module: Guidelines Competition**  
Speakers:      Brad J. Hornberger, MPAS, PA-C  
                         Jessica Nelson, MPAS, PA-C
- 6:30 p.m. - 8:00 p.m.**      **Welcome Reception in Exhibit Hall**  
*Location:      Horizons Ballroom, Salon 9-11, Mezzanine Level*

**SATURDAY, APRIL 2, 2016****OVERVIEW**

- 7:00 a.m. - 11:00 a.m. Exhibit Hall Open**  
Location: Horizons Ballroom, Salon 9-11, Mezzanine Level
- 7:15 a.m. - 6:00 p.m. Registration/Information Desk Open**  
Location: Horizons Ballroom Foyer, Mezzanine Level
- 7:15 a.m. - 8:30 a.m. Industry Satellite Symposium Breakfast**  
Location: Horizons Ballroom, Salon 1-3, Mezzanine Level  
See page 9 for details.

**GENERAL SESSION**

- 8:30 a.m. - 9:00 a.m. Intro to Urodynamics**  
Speaker: Dawn D. Mayberry, CMA, Urodynamicist and Diagnostician
- 9:00 a.m. - 9:45 a.m. Bladder Cancer Treatment**  
Speaker: Vitaly Margulis, MD
- 9:45 a.m. - 10:30 a.m. Perioperative Management After Cystectomy**  
Speaker: Vitaly Margulis, MD
- 10:30 a.m. - 11:00 a.m. Break - Visit with Exhibitors**
- 11:00 a.m. - 12:00 p.m. Prostate Cancer Treatment Complications**  
Speaker: Jeffrey D. Brady, MD
- 12:00 p.m. - 1:00 p.m. Industry Satellite Symposium Lunch**  
Location: Horizons Ballroom, Salon 1-3, Mezzanine Level  
See page 9 for details.
- 1:00 p.m. - 1:40 p.m. Antibiotic Stewardship**  
Speaker: Archana Shah, MD
- 1:40 p.m. - 2:20 p.m. Radiology 101**  
Speaker: Gaurav Khatri, MD
- 2:20 p.m. - 3:00 p.m. Infertility**  
Speaker: Zamip P. Patel, MD
- 3:00 p.m. - 3:15 p.m. Annual Business Meeting**
- 3:15 p.m. - 3:30 p.m. Break**
- 3:30 p.m. - 4:45 p.m. Breakout Session A**

*Please Follow Your Breakout Session Schedule Located on the Back of Your Attendee Badge.*

- 3:30 p.m. - 4:45 p.m. Number 1 - Procedure Skills: Penile Blocks, Treating Priapism, Verapamil and Xiaflex Injections**  
Location: Horizons Ballroom, Salon 5-7, Mezzanine Level  
Speaker: Mary Mathe, PA-C
- 3:30 p.m. - 4:45 p.m. Number 2 - Urodynamics and Pessary Fitting**  
Location: Horizons Ballroom, Salon 4, Mezzanine Level  
Speakers: Tamara Dickinson, RN, CURN, CCCN, BCIA-PMDB  
Dawn D. Mayberry, CMA, Urodynamicist and Diagnostician
- 3:30 p.m. - 4:45 p.m. Number 3 - Female Sexual Dysfunction**  
Location: Horizons Ballroom, Salon 8, Mezzanine Level  
Speakers: Jessica Nelson, MPAS, PA-C  
Brooke Zilinskas, MMS, PA-C
- 3:30 p.m. - 4:45 p.m. Number 4 - Cystoscopy/Difficult Foley Placement**  
Location: Solar, Mezzanine Level  
Speakers: Patrick Dougherty, MPAS, PA-C  
Lisa G. Kerr, BS, MS

## 4:45 p.m. - 6:00 p.m. Breakout Session B

*Please Follow Your Breakout Session Schedule Located on the Back of Your Attendee Badge.*

4:45 p.m. - 6:00 p.m.	<b>Number 1 - Procedure Skills: Penile Blocks, Treating Priapism, Verapamil and Xiaflex Injections</b> <i>Location: Horizons Ballroom, Salon 5-7, Mezzanine Level</i> Speaker: Mary Mathe, PA-C
4:45 p.m. - 6:00 p.m.	<b>Number 2 - Urodynamics and Pessary Fitting</b> <i>Location: Horizons Ballroom, Salon 4, Mezzanine Level</i> Speakers: Tamara Dickinson, RN, CURN, CCCN, BCIA-PMDB Dawn D. Mayberry, CMA, Urodynamicist and Diagnostician
4:45 p.m. - 6:00 p.m.	<b>Number 3 - Female Sexual Dysfunction</b> <i>Location: Horizons Ballroom, Salon 8, Mezzanine Level</i> Speakers: Jessica Nelson, MPAS, PA-C Brooke Zilinskas, MMS, PA-C
4:45 p.m. - 6:00 p.m.	<b>Number 4 - Cystoscopy/Difficult Foley Placement</b> <i>Location: Solar, Mezzanine Level</i> Speakers: Patrick Dougherty, MPAS, PA-C Lisa G. Kerr, BS, MS

## **SUNDAY, APRIL 3, 2016**

### **OVERVIEW**

7:15 a.m. - 10:30 a.m. **Registration/Information Desk Open**  
*Location: Horizons Ballroom Foyer, Mezzanine Level*

7:15 a.m. - 8:15 a.m. **Breakfast**  
*Location: Horizons Ballroom Foyer, Mezzanine Level*

### **GENERAL SESSION**

## 8:00 a.m. - 9:15 a.m. Breakout Session C

*Please Follow Your Breakout Session Schedule Located on the Back of Your Attendee Badge.*

8:00 a.m. - 9:15 a.m.	<b>Number 1 - Procedure Skills: Penile Blocks, Treating Priapism, Verapamil and Xiaflex Injections</b> <i>Location: Horizons Ballroom, Salon 5-7, Mezzanine Level</i> Speaker: Mary Mathe, PA-C
8:00 a.m. - 9:15 a.m.	<b>Number 2 - Urodynamics and Pessary Fitting</b> <i>Location: Horizons Ballroom, Salon 4, Mezzanine Level</i> Speakers: Tamara Dickinson, RN, CURN, CCCN, BCIA-PMDB Dawn D. Mayberry, CMA, Urodynamicist and Diagnostician
8:00 a.m. - 9:15 a.m.	<b>Number 3 - Female Sexual Dysfunction</b> <i>Location: Horizons Ballroom, Salon 8, Mezzanine Level</i> Speakers: Jessica Nelson, MPAS, PA-C Brooke Zilinskas, MMS, PA-C
8:00 a.m. - 9:15 a.m.	<b>Number 4 - Cystoscopy/Difficult Foley Placement</b> <i>Location: Solar, Mezzanine Level</i> Speakers: Patrick Dougherty, MPAS, PA-C Lisa G. Kerr, BS, MS

9:15 a.m. - 9:30 a.m. **Break**

**9:30 a.m. - 10:45 a.m. Breakout Session D**

*Please Follow Your Breakout Session Schedule Located on the Back of Your Attendee Badge.*

<b>9:30 a.m. - 10:45 a.m.</b>	<b>Number 1 - Procedure Skills: Penile Blocks, Treating Priapism, Verapamil and Xiaflex Injections</b> <i>Location: Horizons Ballroom, Salon 5-7, Mezzanine Level</i> Speaker: Mary Mathe, PA-C
<b>9:30 a.m. - 10:45 a.m.</b>	<b>Number 2 - Urodynamics and Pessary Fitting</b> <i>Location: Horizons Ballroom, Salon 4, Mezzanine Level</i> Speakers: Tamara Dickinson, RN, CURN, CCCN, BCIA-PMDB Dawn D. Mayberry, CMA, Urodynamicist and Diagnostician
<b>9:30 a.m. - 10:45 a.m.</b>	<b>Number 3 - Female Sexual Dysfunction</b> <i>Location: Horizons Ballroom, Salon 8, Mezzanine Level</i> Speakers: Jessica Nelson, MPAS, PA-C Brooke Zilinskas, MMS, PA-C
<b>9:30 a.m. - 10:45 a.m.</b>	<b>Number 4 - Cystoscopy/Difficult Foley Placement</b> <i>Location: Solar, Mezzanine Level</i> Speakers: Patrick Dougherty, MPAS, PA-C Lisa G. Kerr, BS, MS

**10:45 a.m. - 11:00 a.m. Closing Remarks****Disclaimer Statement**

*Statements, opinions and results of studies contained in the program are those of the presenters/authors and do not reflect the policy or position of the UAPA nor does the UAPA provide any warranty as to their accuracy or reliability.*

*Every effort has been made to faithfully reproduce the abstracts as submitted. However, no responsibility is assumed by the UAPA for any injury and/or damage to persons or property from any cause including negligence or otherwise, or from any use or operation of any methods, products, instruments or ideas contained in the material herein.*

**John Andrich, PA-C**

Mr. Andrich is a medical provider for Dr. Vipul Patel and the Center for Urologic Cancer in Celebration, Florida. He has been a part of the robotic surgery team for more than two years and has helped continue the excellence Center for Urologic Cancer strives for on a daily basis. He earned his bachelor's degree in biology at the University of Central Florida in 2009 and his master's degree in medical sciences, physician assistant studies at Nova Southeastern University in 2013.

Currently, Mr. Andrich is a member of the American Urological Association, the American Academy of Physician Assistants, the Florida Academy of Physician Assistants, and the Florida Urological Society.

**Jeff Brady MD, FACS**

Dr. Brady is a board-certified urologist born in Syracuse, New York. He received his undergraduate degree from the Jesuit run LeMoyne College and was awarded the William F.J. Ryan Medal in Junior Pure Science and played division I baseball. He obtained his medical degree at the State University of New York (SUNY) Upstate at Syracuse, graduating with multiple honors. This was followed by his urology residency at the University of Miami. Dr. Brady pursued a fellowship in adult and pediatric genitourinary reconstruction at the internationally renowned Devine-Jordan Center in Norfolk, Virginia under Dr. Gerald Jordan. He is the only fellowship-trained physician in urologic reconstructive surgery in central Florida and one of the most experienced in the state. He has been with the same practice in Orlando, Florida, since completing his fellowship in 2000.

Dr. Brady has particular expertise related to men's health including urethral stricture disease, male urinary incontinence (male sling or artificial urinary sphincters), erectile dysfunction (ED- penile prosthesis), hormone replacement therapy (testosterone) and disorders of penile curvature (congenital curvature of the penis and Peyronie's disease).

**Tamara Dickinson, RN, CURN, CCCN, BCIA-PMDB**

Ms. Dickinson is a nationally and internationally recognized authority in urodynamics, incontinence, voiding dysfunction, and pelvic floor dysfunction. Ms. Dickinson is board certified in urology nursing and continence nursing and is certified in biofeedback for pelvic muscle dysfunction.

With 15 years in the field, Ms. Dickinson is experienced in pelvic floor therapy including biofeedback and neurogenic voiding dysfunction, as well as other pelvic floor and continence therapies such as sacral neuromodulation and pessaries. She is a frequent national presenter on these topics.

**Patrick Dougherty, MPAS, PA-C**

Mr. Dougherty has been practicing as a physician assistant in the urology department at UT Southwestern Medical Center since 2012. Prior to working at UTSW, he worked as part of the inpatient urology team at Yale New Haven Hospital in Connecticut. He graduated from PA school in 2009 and, prior to that, worked as an exercise physiologist for North Texas Heart Center conducting nuclear and non-invasive cardiac stress testing. He graduated from Texas A&M University in 2005 with a bachelor of science in applied exercise physiology.

**Tim Hirsch, PA-C**

Mr. Hirsch has been a physician assistant with the Florida Center for Pediatric Urology at the Florida Hospital for Children in Orlando, Florida for nearly five years. He is supervised by Dr. Michael Keating and Dr. Pablo Gomez. He has first-assisted in over 5,000 pediatric urology surgical cases, including over 150 robotic assisted cases using various Da Vinci models. He has participated in the care of over 10,000 patients with many different urologic conditions, including hydronephrosis, vesicoureteral reflux, hypospadias, undescended testes, phimosis and enuresis.

Mr. Hirsch received a Bachelor's of Science in Kinesiology at the Pennsylvania State University. He then graduated with a Master's of Medical Science from Arcadia University in Glenside, Pennsylvania. Prior to working at the Florida Center for Pediatric Urology, Mr. Hirsch worked as a physician assistant at Arnold Palmer Hospital with pediatric neurosurgery.

**Brad Hornberger, MPAS, PA-C**

Mr. Hornberger is a physician assistant in the department of urology at UT Southwestern Medical Center. He has been practicing as a urology PA since graduating from Missouri State University's PA program in 2002. His clinical interests include general urology with a special interest in male sexual dysfunction. In addition, he serves as a co-investigator in several clinical trials. He frequently lectures for the UT Southwestern PA program and has presented on a wide variety of topics for locally and nationally.

He has served on board of directors and as a chair of the CME Committee for the Texas Academy of Physician Assistants and the Urological Association of Physician Assistants. He is the program director of a postgraduate training program for physician assistants specializing in urology.

**Lisa G. Kerr, BS, MS**

Ms. Kerr completed both her undergraduate and graduate education at Daemen College in Amherst, New York. After graduating from PA school in 2011, she moved to Virginia where she practiced in gastroenterology for a year and a half. She then transitioned into urology. After working in urology for one year, she applied and was accepted into a fellowship program with UT Southwestern Medical Center in their urology department. Upon completion of said program, Ms. Kerr began working in the urology department of Parkland Hospital in Dallas, Texas, where she is currently employed.

**Gaurav Khatri, MD**

Dr. Khatri earned his medical degree from the University of Alabama School of Medicine, as well as went on to finish his internship with the same university. He went on to complete his residency with NSLIJHS-North Shore University Hospital in diagnostic radiology. He then continued to complete a fellowship in abdominal imaging with Northwestern University, Feinberg School of Medicine.





**Charlene Kreiensieck, PA-C**

Ms. Kreiensieck is a member of the Laconia Clinic, and has been practicing as a physician assistant for the past 14 years specializing in urology. She also takes a keen interest in internal medicine and general surgery.

Charlene takes pride in her teaching position, as an adjunct professor at the Massachusetts College of Pharmacy and Health Science, as well as being an adjunct professor at Franklin Pierce University.

Charlene earned a Bachelor of Science in Medical Technology at the University of New Hampshire. She then went on to earn a Master of Physician Assistant Studies from Notre Dame College, in Manchester, New Hampshire. Her experience and teaching continue to be a contribution to the UAPA community.



**Vitaly Margulis, MD**

Dr. Margulis is an associate professor of urology at UT Southwestern Medical Center, graduated with honors from the University of Texas at Austin and UT Southwestern Medical School. He trained in the highly competitive urology residency program at UT Southwestern and completed a fellowship in urologic oncology at the University of Texas MD Anderson Cancer Center in Houston, where he was previously a clinical specialist in urologic oncology. He joined the UT Southwestern faculty in 2009.



**Mary Mathe, PA-C**

Ms. Mathe currently works at Florida Urology Associates with Dr. Jeffrey Brady. She graduated from Rochester Institute of Technology with a degree in physician assistant studies and has 12+ years of experience in taking care of urological patients. She was appointed as the first PA to the Education Council of the American Urological Association and was the first Chair of the American Urological Association Non-Physician Provider Education Committee. She is a former co-chair of APNPA (Advanced Practice Nurses and Physician Assistants), specific educational programs that are held in conjunction with the AUA annual meeting well as the first PA speaker at a plenary session, talking on the Utilization of APNPA's.

Ms. Mathe previously practiced in upstate New York at University Urology, was then recruited to the Global Robotics Institute in Celebration, Florida with Dr. Vipul Patel, where she built their Penile Rehabilitation Program. Her professional areas of practice include urologic cancer, sexual medicine and men's health.

She also spent some time working as a medical science liaison, supporting genomic test for both prostate and bladder cancer.

Ms. Mathe is certified by the National Commission for Certification of Physician Assistants. She is a member of the American Urological Association, the Urological Association of Physician Assistants and the Florida Urological Society. She continues to be a leader in her fields of expertise with multiple publications and speaking engagements.



**Dawn Mayberry, Urodynamicist, Diagnostician**

Ms. Mayberry has been seeing patients with bladder problems for over 23 years. She received training at University of Michigan where she also had intensive training in clinical urodynamics, as well as developed the skill to interpret the information correctly. She learned to evaluate pediatric, spinal cord, female voiding dysfunction, and BPH/prostate CA as it relates to bladder function.

Ms. Mayberry has been an independent contractor for most of her career; however, she has also worked for companies that offer testing equipment and treatment options, which has afforded her the opportunity to have a complete understanding of the business side of our industry.



**Kenneth A. Mitchell, MPAS, PA-C**

Mr. Mitchell is a certified physician assistant with over 20 years of clinical experience overall and with over 18 years of experience in male erectile and sexual dysfunction. He has authored and implemented an innovative treatment protocol The Surgical Impotence Management Strategy (SIMS®) protocol that includes comprehensive patient education and delivery of care. Also, he has participated in numerous research trials in sexual dysfunction and continues to be active in this area. Mr. Mitchell actively promotes men's health and has participated in community outreach programs to educate men about sexual health. He has lectured both nationally and internationally on the subject of men's health and sexual dysfunction. He is a co-author of the AUA Consensus Statement on Advanced Practice Providers (APP) and has given multiple presentations and published articles on the subject of integration of APP's

in a urology practice. Ken recently became the Founding Program Director of the Meharry Medical College Physician Assistant Program.

Mr. Mitchell is currently a fellow of the American Academy of Physician Assistants (AAPA), Urological Association of Physician Assistants (UAPA), Minnesota Academy of Physician Assistants (MAPA), Minnesota Urologic Society (MUS), and is an associate member of the Sexual Medicine Society of North America. He is the vice chair of the AUA APN/PA Membership Committee and will ascend to a chairman of the AUA APN/PA Membership Committee in May. He is a past president of the Urological Association of Physician Assistants (UAPA) completing two consecutive terms as President, chair of the Sexual Medicine Society of North America APN/PAAffairs Committee, and board member at-large of the American Society of Men's Health (ASMH). Mr. Mitchell received his undergraduate degree from Dana College (1988), and his master's in physician assistant studies (MPAS) at the University of Nebraska Physician Assistant Program (1995).



**Jessica Nelson, MPAS, PA-C**

Ms. Nelson is a physician assistant at UT Southwestern Medical Center in Dallas, Texas. She has been working there specializing in urology since 2010. Her interests include, but are not limited to: female urology, neurological diseases, nephrolithiasis, and kidney cancer. She enjoys the balance between clinic, inpatient medicine and assisting on laparoscopic robotic surgeries. She enjoys giving lectures to the PA Students at UTSW and serving as a preceptor.

Jessica has served as secretary of the Urological Association of Physician Assistants since 2013 and as a member of the education committee since 2012. Currently, she is the education chair. She is a member of the Texas Association of Physician Assistants, as well as the American Urological Association.

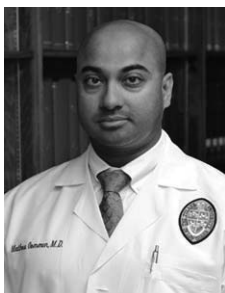

**Mathew Oommen, MD**

Dr. Oommen earned his medical degree from Ross University School of Medicine Portsmouth, Dominica and completed an internship with Staten Island University Hospital. He went on to a residency with Ochsner Clinic Foundation in Louisiana. He then completed a clinical research fellowship in robotics with the department of urology at Tulane University Health Sciences Center. Dr. Oommen currently works with Florida Urology Associates in Orlando, Florida.



**Mark N. Painter**

Mark N. Painter is a managing partner of PRS Consulting, LLC, CEO of PRS Urology Service Corporation and Vice President of coding and reimbursement information for Physician Reimbursement Systems, Inc. (PRS). Since co-founding PRS in 1989, Mr. Painter has served as the primary coding resource for the PRS products including hotlines, coding manuals and quick reference tools, the internet-based application codingtoday.com and seminars. He has lectured to a variety of groups concerned with health care reimbursement. Mr. Painter's extensive knowledge of physician reimbursement issues has allowed him to assist insurance companies, physicians and their staff members, legal counsel, actuaries, specialty societies and consultants on a daily basis. His serves has an expert to legal counsel, bio device companies and pharmaceuticals. He is a co-chair of the Colorado Clean Claims Task Force, a

committee of nationally known industry experts charged with the development of single payment edit database for the state.



**Zamip Patel, MD**

Dr. Patel is board certified in urology and one of the few urologists in central Florida that is fellowship-trained in andrology (male infertility). Dr. Patel completed urology residency at the Mount Sinai School of Medicine in New York, followed by an andrology fellowship at the University of Illinois in Chicago. He is an associate professor at the UCF School of Medicine, as well as the Laboratory and Medical Director of the U.S. operations of Cryos International, the largest cryopreservation/sperm bank in the world. He is Chief of Surgery at Florida Hospital East Orlando. He practices in Orlando.



**Archana K. Shah, MD**

Dr. Shah graduated from B.J. Medical College, Gujarat University, Ahmedabad in Gujarat, India in 1993. She currently works in Winter Park, Florida and specializes in infectious disease and internal medicine. Dr. Shah is affiliated with Winter Park Memorial Hospital.



**Richard D. Ulstad MS, PA-C, CCD**

Mr. Ulstad is a urological physician assistant at Urology Associates of SENC, PA. As a urological PA, his interests include but aren't limited to: urogynecological diseases, hypogonadism, kidney stones, renal and bladder cancer, prostate cancer, interstitial cystitis, BPH, male and female sexual dysfunction, ED, male and female incontinence and voiding dysfunction. He specializes in all aspects of adult and pediatric urology.

Currently, Dr. Ulstad is President of the Cape Fear Chapter Society of SENC PA's, as well as, Vice President of the National Urologic Academy of Physician Assistants. He is also a member of the AUA, AAPA and the NCAPA. Additionally, he is a board-certified clinical densitometrist. Dr. Ulstad attended the University of Rochester, in Rochester, New York, where he specialized in medicine, business, psychology and Spanish. With a full scholarship, he attended Graduate School at Northeastern University in Boston, Massachusetts.



**G. Brooke Zilinskas, MMS, PA-C**

Ms. Zilinskas completed her physician's assistant degree at Midwestern University in Downers Grove, Illinois and went on to work in general and vascular surgery before ending up in urology. For the past six years, she has worked in the urology department at UT Southwestern Medical Center in Dallas, Texas. There, she sees patients in the clinic with a focus on female urology and voiding dysfunction, performs cystoscopies, prostate biopsies, and PTNS nerve stimulation treatments. She also first-assists on all types of urologic robotic cases. She has lectured for the PA school, as well as at local, state, and national level on topics of incontinence, pelvic pain, and vaginal mesh complications. She has published in *Journal of the American Academy of Physician Assistants* on unique causes of voiding dysfunction and is the head of the advanced practice provider mentorship program at UT Southwestern.

# MARK YOUR CALENDARS!

AUA 2016 ANNUAL MEETING

May 6 - 10, 2016

San Diego Convention Center

San Diego, California

American Academy of Physician Assistants  
44<sup>TH</sup> ANNUAL PHYSICIAN ASSISTANT CONFERENCE

May 14- 18, 2016

San Antonio, Texas

FOR MORE INFORMATION:

AUA – [www.aua2016.org](http://www.aua2016.org)

AAPA – [www.aapaconference.org](http://www.aapaconference.org)

---

**UA**

**PA**

**UROLOGICAL ASSOCIATION  
OF  
PHYSICIAN ASSISTANTS**

---

Urological Association of Physician Assistants

Two Woodfield Lake

1100 E Woodfield Road, Suite 350

Schaumburg, Il 60173-5116

Phone: (847) 517-7225

Fax: (847) 517-7229

[uapainfo@uapanet.org](mailto:uapainfo@uapanet.org)